

Control Box Assembly

This control box will retrofit any 7x10 or 7x12 mini lathe. Unplug the power cord from the wall receptacle. Then remove the old control box by removing the four mounting screws, and then disconnecting the motor leads, the power cord, and the ground wire.

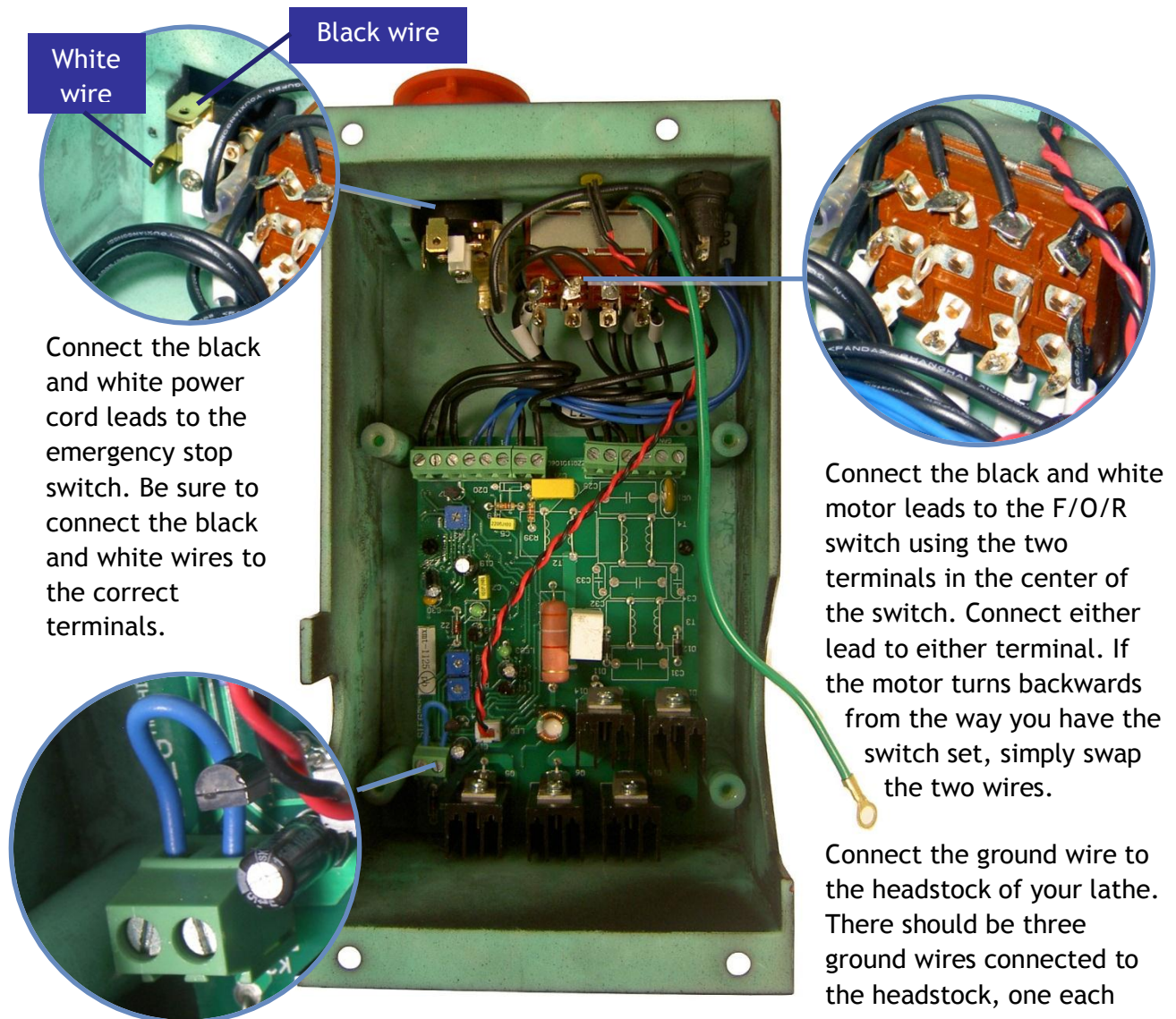

White wire
Black wire

Connect the black and white power cord leads to the emergency stop switch. Be sure to connect the black and white wires to the correct terminals.

Connect the black and white motor leads to the F/O/R switch using the two terminals in the center of the switch. Connect either lead to either terminal. If the motor turns backwards from the way you have the switch set, simply swap the two wires.

Connect the ground wire to the headstock of your lathe. There should be three ground wires connected to the headstock, one each from the control box, the motor, and the power cord.

If your lathe has a safety switch (usually on a chuck guard) remove the jumper wire from the K3 and K4 terminals and connect the switch leads to these terminals. You can connect either lead to either terminal.

Replace the clear plastic shield if you removed it.

Test your control box before you screw it on the lathe. Make sure the motor functions and turns in the direction indicated by the F/O/R switch. If the rotation is backwards, swap the two motor leads on the F/O/R switch.

